



18LHF

Multi-drop hot runner nozzle for side gating under 90°, without cold slugs, thick-film heating element (BlueFlow®) and heated adapter

TECHNICAL DATA

18LHF

Melt channel Ød	3.8 mm	
Operating voltage	230 V _{AC} *	
Quantity of tips	1, 2 or 4	
Nominal length of the nozzle (L) in mm		
60	80	100
■	■	■

AHJ5

Operating voltage	230 V _{AC} *
Adapter	straight (G)/radius (R)/ angle (W)

*Volts alternating current

■ available

NOTE

Power connector CHF and thermocouple connector CMLK are to be ordered separately.

BlueFlow® hot runner nozzle type 18LHF is not intended for sale or use in the USA or Canada!



PLUG LOCATION RELATIVE TO TIP

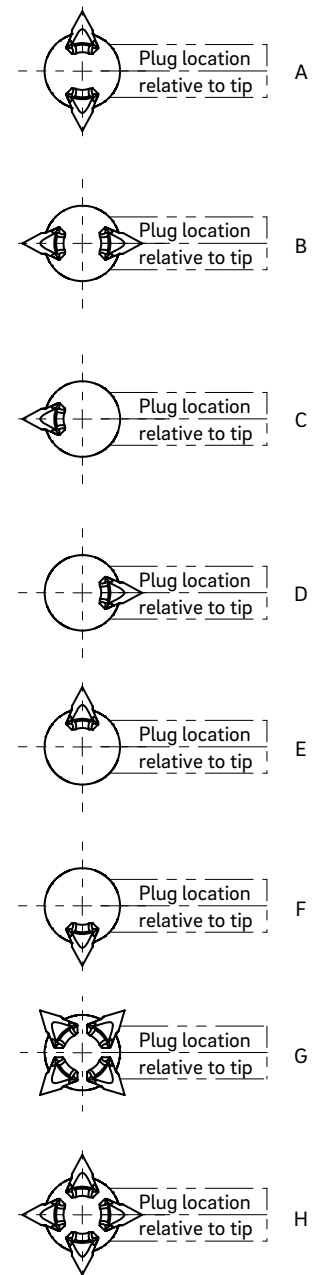

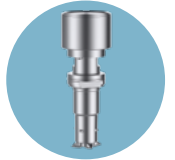

INSTALLATION

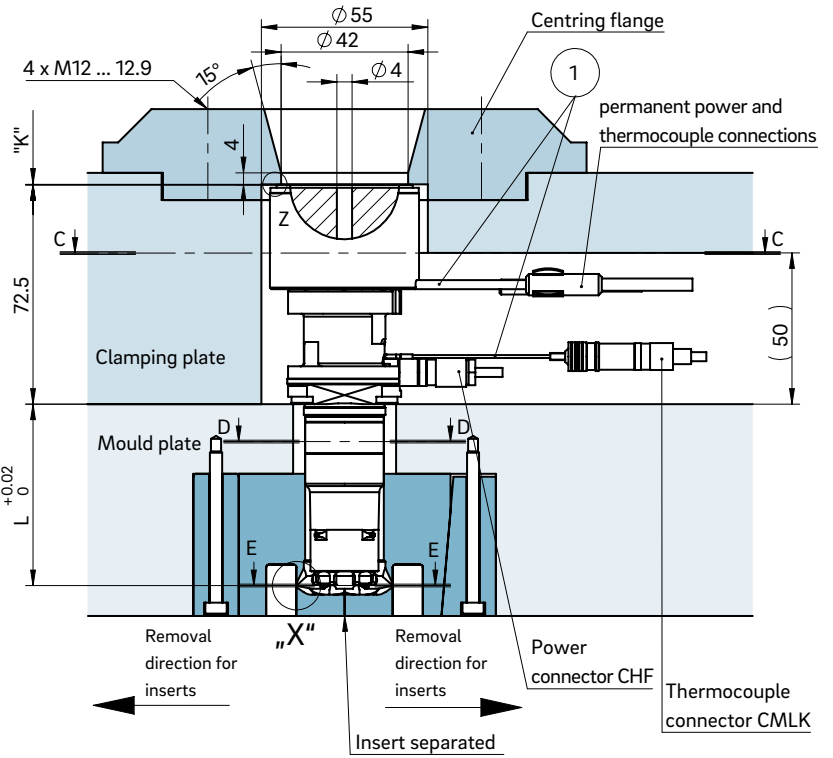
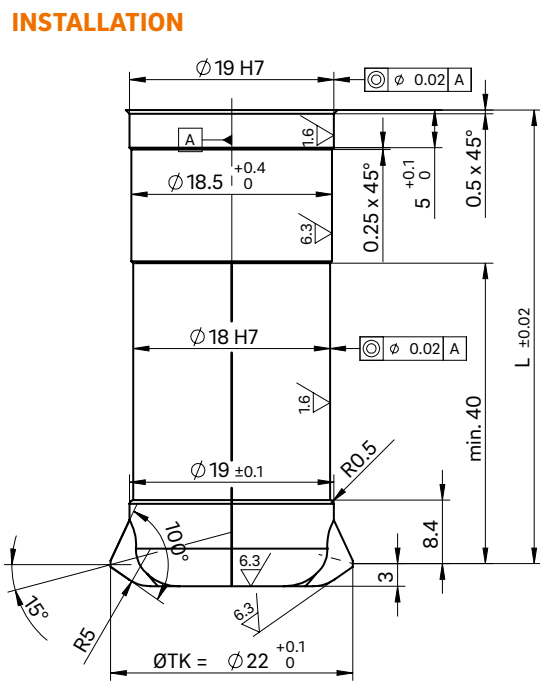

View D-D for two nozzle tips

View D-D for four nozzle tips

View C-C cutout for nozzle head, power and thermocouple plug connections

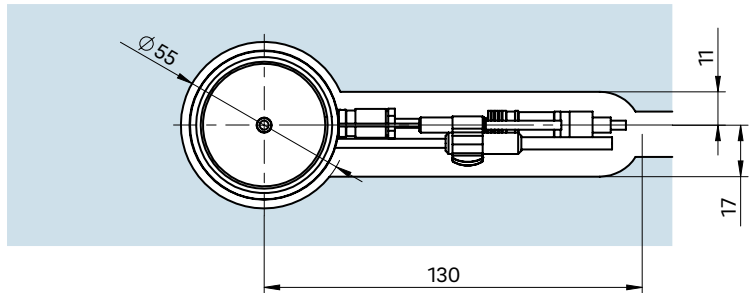
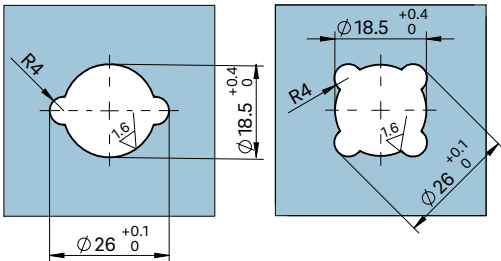

View E-E for two nozzle tips

View E-E for four nozzle tips

Detail "X"

① Thermocouple plug connection in this area can only be bent once; minimum radius: R8 SW = flat area on nozzle head

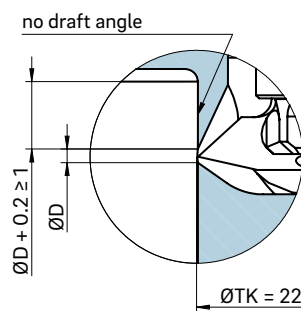
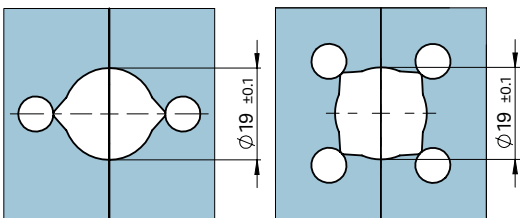

Turning prevention

To prevent open jet formations, injection should be carried out against a core, for example.

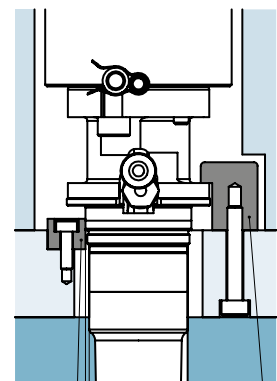

Detail "Z"

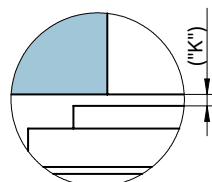

Dimension "K" required for heat expansion is to be ensured by grinding the location ring! Determine the difference between the height of the nozzle (with adapter) and the height of the structure when installed! ΔT specifies the temperature differential between the processing temperature and the mould temperature!

ΔT (°C)	100	150	200	250	300	350
K (mm)	0.06	0.08	0.09	0.11	0.13	0.16