



Gate bushing type VA/VAV

Versions VA and VAV with wear protection

TECHNICAL DATA

Dimensions

	Version (mm)									
	ØA	ØS	ØT ₁	s	ØA ₁	R	ØP	t ₁	t	
15VA	35	15	22	5	36	5	12	2.3	2.5	
20VA	35	20	28	5	36	5	16	2.3	2.5	
22VA/VAV	38	22	32	5	39	8	16	2.3	2.5	
26VA/VAV	45	26	36	5	46 ^{1,2}	8	16	2.3	2.5	
32VA/VAV	50	32	42	9	56	13	20	3.3	3.5	
38VA/VAV	59	38	48	12	60	16	26	4.3	4.5	

¹ØA₁ = 49 mm with nozzle type 8SET/8DET

²ØA₁ = 56 mm with nozzle type 8SHT

NOTE

When using a gate bushing of size ØS = 26 mm, ØS = 32 mm or ØS = 38 mm in conjunction with nozzle types _ET and _HT, we recommend consulting with the engineers.

After eroding the gate bushing, it must be annealed to remove stress (1 hour at 470 °C).



ANTECHAMBER VERSIONS A/B

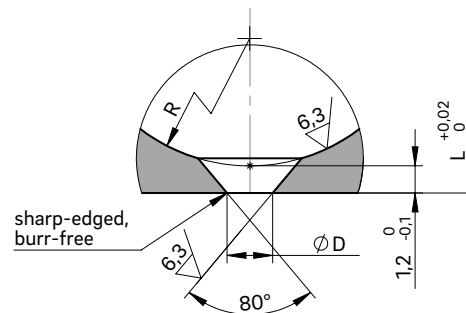

For open nozzles with a tip/open nozzles with a straight outlet for antechamber versions A/B and nozzle piece C

WEBCODE
23050



GATE BUSHING INSTALLATION

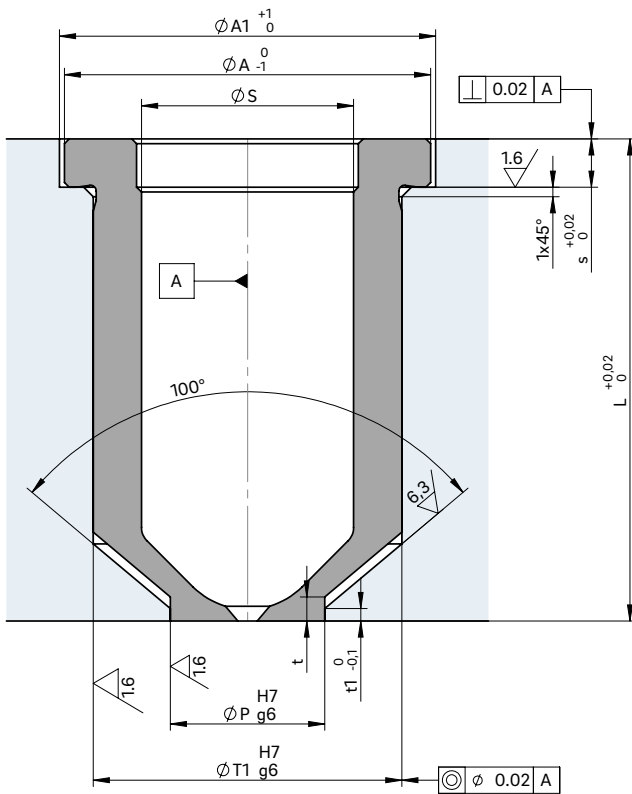

Nozzle type designation	Gate bushing type/length (mm)																	
	L=50		L=60		L=80		L=100		L=120									
4SHF/4DHF	■	15VA	■	15VA	■	15VA												
4STT/4DTT	■	15VA	■	15VA	■	15VA												
4SMT/4DMT	■	20VA	■	20VA	■	20VA	■	20VA										
5SHT/5DHT	■	22VA	□	22VAV	■	22VA	□	22VAV	■	22VA	□	22VAV						
5SMT/5DMT	■	22VA	□	22VAV	■	22VA	□	22VAV	■	22VA	□	22VAV	■	22VA	□	22VAV		
6SHF/6DHF	■	22VA	□	22VAV	■	22VA	□	22VAV	■	22VA	□	22VAV	■	22VA	□	22VAV		
6STT/6DTT	■	22VA	□	22VAV	■	22VA	□	22VAV	■	22VA	□	22VAV	■	22VA	□	22VAV		
6SHT/6DHT	■	26VA	□	26VAV	■	26VA	□	26VAV	■	26VA	□	26VAV	■	26VA	□	26VAV		
6SMT/6DMT	■	26VA	□	26VAV	■	26VA	□	26VAV	■	26VA	□	26VAV	■	26VA	□	26VAV		
8SET/8DET	■	26VA	□	26VAV	■	26VA	□	26VAV	■	26VA	□	26VAV	■	26VA	□	26VAV		
8SHF/8DHF	■	26VA	□	26VAV	■	26VA	□	26VAV	■	26VA	□	26VAV	■	26VA	□	26VAV		
8SHT/8DHT	■	26VA	□	26VAV	■	26VA	□	26VAV	■	26VA	□	26VAV	■	26VA	□	26VAV		
8SMT/8DMT	■	26VA	□	26VAV	■	26VA	□	26VAV	■	26VA	□	26VAV	■	26VA	□	26VAV		
10SHT/10DHT			■	32VA	□	32VAV	■	32VA	□	32VAV	■	32VA	□	32VAV	■	32VA	□	32VAV
10SMT/10DMT			■	32VA	□	32VAV	■	32VA	□	32VAV	■	32VA	□	32VAV	■	32VA	□	32VAV
12SET/12DET			■	38VA	□	38VAV	■	38VA	□	38VAV	■	38VA	□	38VAV	■	38VA	□	38VAV
12SHT/12DHT			■	38VA	□	38VAV	■	38VA	□	38VAV	■	38VA	□	38VAV	■	38VA	□	38VAV
12SMT/12DMT			■	38VA	□	38VAV	■	38VA	□	38VAV	■	38VA	□	38VAV	■	38VA	□	38VAV

■ available □ on request