



# Gate bushing type VB

## Versions VB

### TECHNICAL DATA

#### Dimensions

|             | Version (mm)    |                 |                   |   |                   |   |                 |       |     |  |
|-------------|-----------------|-----------------|-------------------|---|-------------------|---|-----------------|-------|-----|--|
|             | $\varnothing A$ | $\varnothing S$ | $\varnothing T_1$ | s | $\varnothing A_1$ | R | $\varnothing P$ | $t_1$ | t   |  |
| <b>18VB</b> | 38              | 18              | 26                | 5 | 39 <sup>1</sup>   | 8 | 16              | 2.3   | 2.5 |  |

<sup>1</sup> $\varnothing A_1 = 43$  mm with nozzle type 5SEF/5DEF

### NOTE

After eroding the gate bushing, it must be annealed to remove stress (1 hour at 470 °C).



### ANTECHAMBER VERSIONS A/B

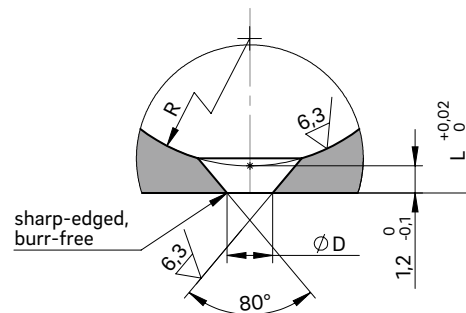

For open nozzles with a tip/open nozzles with a straight outlet for antechamber versions A/B and nozzle piece C

**WEBCODE**  
23055



**GATE BUSHING INSTALLATION**

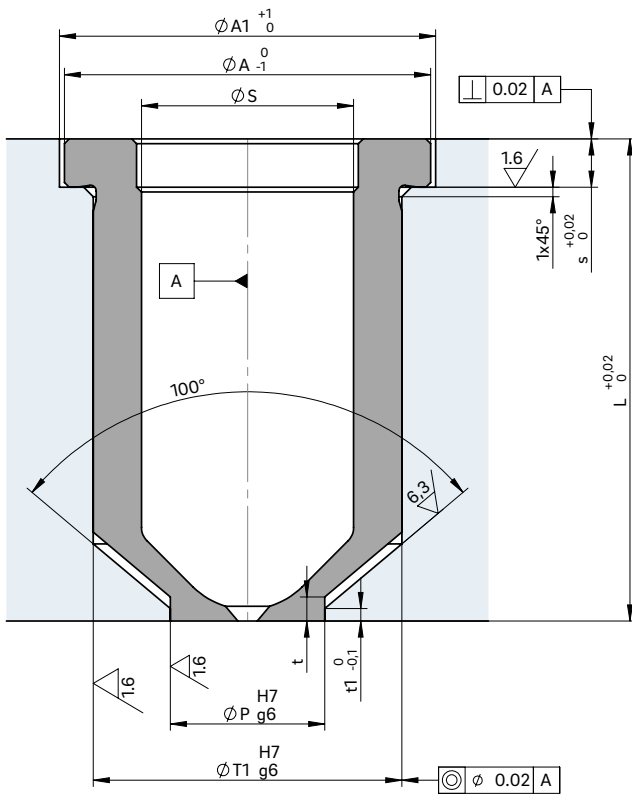

| Nozzle type designation | Gate bushing type/length (mm) |        |        |         |
|-------------------------|-------------------------------|--------|--------|---------|
|                         | L = 50                        | L = 60 | L = 80 | L = 100 |
| 5SEF/5DEF               | ■ 18VB                        | ■ 18VB | ■ 18VB |         |
| 5SHF/5DHF               | ■ 18VB                        | ■ 18VB | ■ 18VB | ■ 18VB  |
| 5STT/5DTT               | ■ 18VB                        | ■ 18VB | ■ 18VB | ■ 18VB  |

■ available