



## Hot runner nozzle type 8SMF-K/8DMF-K

Open system nozzle with thick-film heating element (BlueFlow®), not screwed to the manifold

### TECHNICAL DATA

#### 8SMF-K/8DMF-K

Melt channel Ød	7.5 mm
Nozzle type	SMF – open with tip DMF – open with straight outlet
Operating voltage	230 V <sub>AC</sub> *
Nominal length of the nozzle (L):	30 mm

\*Volts alternating current

### NOTE

Can **also** be used laterally.

**BlueFlow® hot runner nozzle type SMF/DMF is not intended for sale or use in the USA or Canada!**



SMF – open nozzle with tip  
version "Tip"  
Antechamber version A

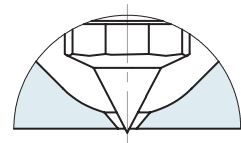

DMF – open nozzle with straight outlet  
version C  
Antechamber version A

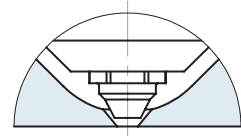

DMF – open nozzle with straight outlet  
version A  
Antechamber version C

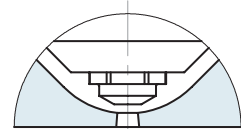

WEBCODE  
22130



## INSTALLATION

Open nozzle with tip  
Nozzle type version C  
Antechamber version A

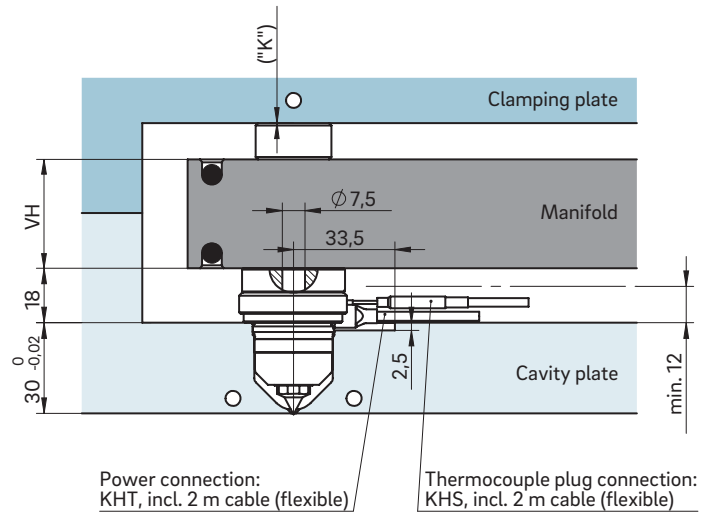
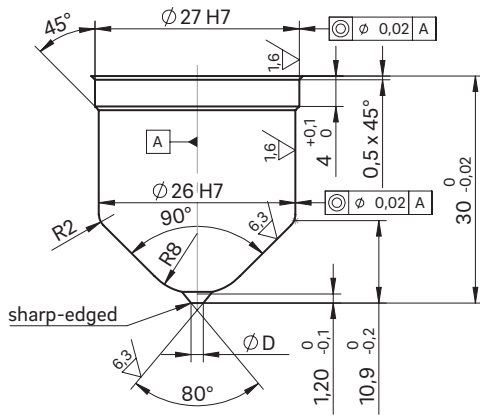

Example cutout for nozzle head, power and thermocouple plug connections

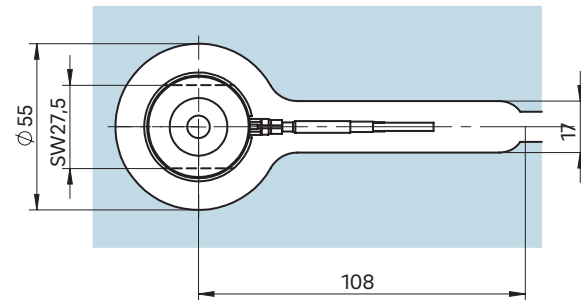

SW = flat area on nozzle head

Open nozzle with straight outlet  
Nozzle type version A  
Antechamber version C

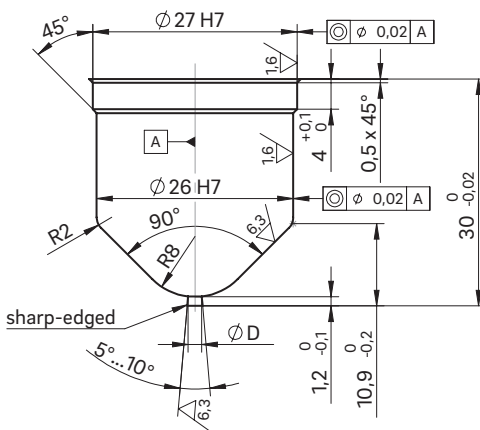

Dimension "K" required for heat expansion is to be ensured by grinding the pressure pad (12 + 0.1 mm)! Determine the difference between the height of the manifold system and the height of the clamping plate when installed! ΔT specifies the temperature differential between the processing temperature and the mould temperature!

VH	ΔT (°C)	100	150	200	250	300	350
36 mm	K (mm)	0.021	0.059	0.098	0.137	0.177	0.217
46 mm	K (mm)	0.033	0.078	0.124	0.170	0.218	0.264
56 mm	K (mm)	0.046	0.097	0.150	0.203	0.258	0.311