



**Valve gate systems**



## Manifold systems

Different manifold versions can be selected for different applications, from partially or fully balanced to customer-specific special solutions. Flexible positioning of hot runner nozzles with a manifold make individualised mould design possible.

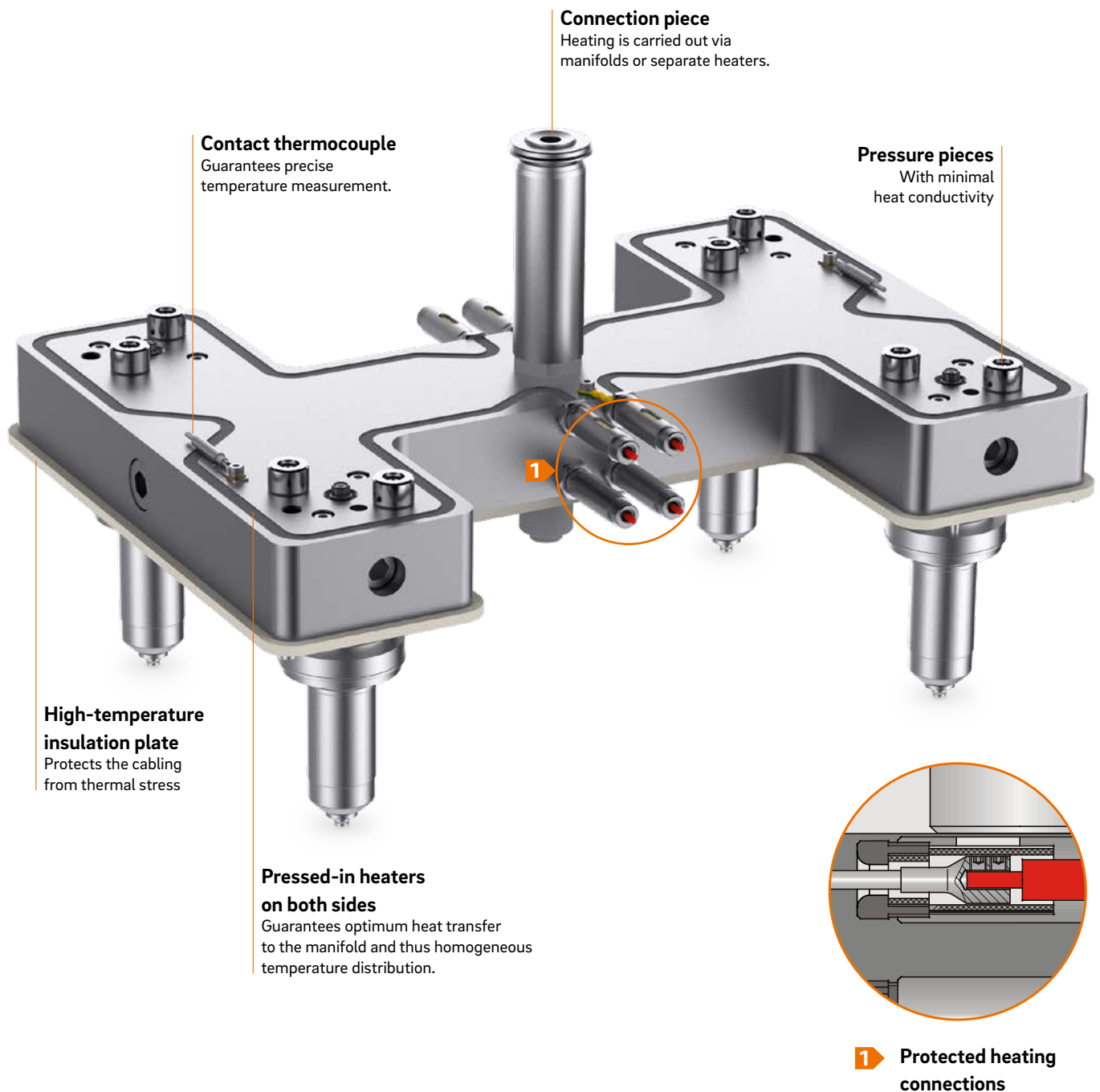

## HOMOGENEOUS TEMPERATURE MANAGEMENT THANKS TO PRESSED-IN HEATERS

All melt-conducting components are heated externally, which ensures optimum plastic flow with the smallest possible pressure loss. Pressed-in heaters on both sides guarantee optimum heat transfer to the manifold block. This results in homogeneous temperature distribution.

## PROTECTED POWER CONNECTIONS – HIGHLY MAINTENANCE FRIENDLY

Steel and ceramic sleeves protect the power connections from damage. Mechanical cleaning of the manifold channels is easy and fast. Cleaning in the fluid bed bath and oven is also possible. The model data in the CADHOC® System Designer library can be configured (and are thus quickly available) for both individual and standard manifolds.

## CADHOC® SYSTEM DESIGNER – TOP-NOTCH SOFTWARE PROVIDED FOR YOUR SUPPORT

CADHOC® System Designer enables us to meet your needs for fast provision of product data on everything from individual components to complete hot runner systems, including negative volume.

Among other things, CADHOC® System Designer enables you to:

- Design nozzle sizes in an optimum way
- Select plastic types from a comprehensive list
- Make a direct configuration without any specifications of the processing parameters
- Make an application-based configuration with specifications of the processing parameters

3D CAD models on every hot runner system are available for download in a variety of different data formats. After entering your configuration parameters, you will receive an e-mail with a link to the product data of the configured hot runner system.

### THE ADVANTAGES AT A GLANCE

- + Homogeneous temperature distribution
- + Variable nozzle positions
- + Power connections with external damage protection
- + Easy and fast cleaning
- + Model data is stored in the CADHOC® online library





# Rapid Systems – Valve Gate Systems, pneumatic

Fully configured valve gate system comprised of manifolds, nozzles and accessories.  
Delivery time three working weeks.

N91

## NGCP1-1 SERIES

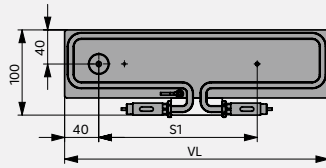

Manifold length (VL)	Pitch (S1 mm) for nozzle type 6NHF + ENV	Pitch (S1 mm) for nozzle type 6NHF + EEV
160	≥ 54 - 85	≥ 45.5 - 85
210	> 85 - 135	> 85 - 135
260	> 135 - 185	> 135 - 185
310	> 185 - 235	> 185 - 235
360	> 235 - 285	> 235 - 285

N93

## NGCP2-1 SERIES

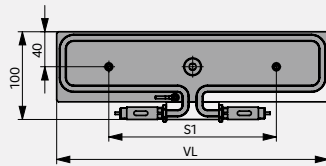

Manifold length (VL)	Pitch (S1 mm) for nozzle type 6NHF + ENV	Pitch (S1 mm) for nozzle type 6NHF + EEV
210	≥ 108 - 140	≥ 91 - 140
260	> 140 - 190	> 140 - 190
310	> 190 - 240	> 190 - 240
360	> 240 - 290	> 240 - 290

N94

## NGCP4B SERIES

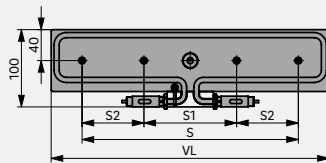

Manifold length (VL)	Pitch S=total (min. to max.) mm for nozzle type 6NHF + EEV
310	≥ 207 - 240
360	> 240 - 290

**6NHF NOZZLE TYPE + ENV**

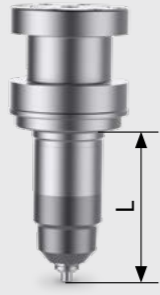

**6NHF NOZZLE TYPE + EEV**

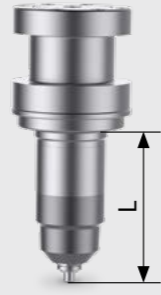

**8NMT3 NOZZLE TYPE + ENV**



**8NMT3 NOZZLE TYPE + EEV**



Pitch (S1 mm) for nozzle type 8NMT3 + ENV	Pitch (S1 mm) for nozzle type 8NMT3 + EEV
≥ 54 - 75	≥ 45.5 - 75
> 75 - 125	> 75 - 125
> 125 - 175	> 125 - 175
> 175 - 225	> 175 - 225
> 225 - 275	> 225 - 275

**Melt channel Ø (mm) / nozzle length (L mm)**

6 / 50, 60, 80

Smallest pitch S1 ≥ 54  
 - Needle guide type: LA1.2 to 1.6 / LAZ1.2 to 1.6  
 - Configuration option: S-096<sup>1</sup>  
 - Needle drive: ENV3/10/L/(G<sup>2</sup>)  
 - Connecting nozzle type: AKD6

**Melt channel Ø (mm) / nozzle length (L mm)**

6 / 50, 60, 80

Smallest pitch S1 ≥ 45.5  
 - Needle guide type: LA1.2 to 1.6 / LAZ1.2 to 1.6  
 - Configuration option: S-096<sup>1</sup>  
 - Needle drive: EEV2-3/10/L/(G<sup>2</sup>)  
 - Connecting nozzle type: AKD6

**Melt channel Ø (mm) / nozzle length (L mm)**

7.5 / 50, 60, 80

Smallest pitch S1 ≥ 54  
 - Needle guide type: LA1.6 to 2.5 / LAZ1.6 to 2.5  
 - Configuration option: S-096<sup>1</sup>  
 - Needle drive: ENV3/10/L/(G<sup>2</sup>)  
 - Connecting nozzle type: AKD8

**Melt channel Ø (mm) / nozzle length (L mm)**

7.5 / 50, 60, 80

Smallest pitch S1 ≥ 45.5  
 - Needle guide type: LA1.6 to 2.5 / LAZ1.6 to 2.5  
 - Configuration option: S-096<sup>1</sup>  
 - Needle drive: EEV2-3/10/L/(G<sup>2</sup>)  
 - Connecting nozzle type: AKD8

Pitch (S1 mm) for nozzle type 8NMT3 + ENV	Pitch (S1 mm) for nozzle type 8NMT3 + EEV
= 120	≥ 103 - 120
> 120 - 170	> 120 - 170
> 170 - 220	> 170 - 220
> 220 - 270	> 220 - 270

**Melt channel Ø (mm) / nozzle length (L mm)**

6 / 50, 60, 80

Smallest pitch S1 ≥ 108  
 - Needle guide type: LA1.2 to 1.6 / LAZ1.2 to 1.6  
 - Configuration option: S-096<sup>1</sup>  
 - Needle drive: ENV3/10/L/(G<sup>2</sup>)  
 - Connecting nozzle type: AKD8

**Melt channel Ø (mm) / nozzle length (L mm)**

6 / 50, 60, 80

Smallest pitch S1 ≥ 91  
 - Needle guide type: LA1.2 to 1.6 / LAZ1.2 to 1.6  
 - Configuration option: S-096<sup>1</sup>  
 - Needle drive: EEV2-3/10/L/(G<sup>2</sup>)  
 - Connecting nozzle type: AKD8

**Melt channel Ø (mm) / nozzle length (L mm)**

7.5 / 50, 60, 80

Smallest pitch S1 ≥ 120  
 - Needle guide type: LA1.6 to 2.5 / LAZ1.6 to 2.5  
 - Configuration option: S-096<sup>1</sup>  
 - Needle drive: ENV3/10/L/(G<sup>2</sup>)  
 - Connecting nozzle type: ASD10

**Melt channel Ø (mm) / nozzle length (L mm)**

7.5 / 50, 60, 80

Smallest pitch S1 ≥ 103  
 - Needle guide type: LA1.6 to 2.5 / LAZ1.6 to 2.5  
 - Configuration option: S-096<sup>1</sup>  
 - Needle drive: EEV2-3/10/L/(G<sup>2</sup>)  
 - Connecting nozzle type: ASD10

**Melt channel Ø (mm) / nozzle length (L mm)**

6 / 50, 60, 80

Smallest pitch S1 ≥ 108  
 Smallest pitch S2 ≥ 67  
 - Needle guide type: LA1.2 to 1.6 / LAZ1.2 to 1.6  
 - Configuration option: S-096<sup>1</sup>  
 - Needle drive: ENV3/10/L/(G<sup>2</sup>)  
 - Connecting nozzle type: AKD8

**Melt channel Ø (mm) / nozzle length (L mm)**

6 / 50, 60, 80

Smallest pitch S1 ≥ 91  
 Smallest pitch S2 ≥ 58  
 - Needle guide type: LA1.2 to 1.6 / LAZ1.2 to 1.6  
 - Configuration option: S-096<sup>1</sup>  
 - Needle drive: EEV2-3/10/L/(G<sup>2</sup>)  
 - Connecting nozzle type: AKD8

You can create CAD data and price information via the CADHOC portal. When configuring your Rasant system, you will be asked for the necessary information about the application and the mould.

**RAPID SYSTEM – VALVE GATE SYSTEMS, PNEUMATIC**

Consisting of:

- 1 Connecting nozzle type AKD or ASD incl. titanium ring
- 2/4/8 Pressure pads
- 1 Manifold, insulating plate optional
- 1 Contact thermocouple 151 HF
- 1/2/4 Nozzle type NHF, NMT3
- 1/2/4 Power connector CHF (NHF), fixed power connection (NMT3)
- 1/2/4 Thermocouple plug CMLK (NHF), fixed thermocouple connection (NMT3)
- 1 Spacer
- 1/2/4 Needle guide (LA/LAZ)
- 1/2/4 Single-needle valve ENV, pneumatic
- 1/2/4 Single-needle valve EEV, pneumatic
- 1/2/4 Sealing needles

Cylindrical pin to prevent rotation is not included in the scope of delivery.

**ORDER**

You choose:

1. Manifold Rapid series NGCP2-1		N 93							
2. Manifold length 210 mm	(21)	N 93		21					
3. Melt channel Ø 6 mm	(06)	N 93		21		06			
4. Nozzle length 60 mm	(06)	N 93		21		06		06	
5. Nozzle type NHF	(HF)	N 93		21		06		06	
6. Model	(-1)	N 93		21		06		06	
7. Pneumatic drive	(-ENV)	N 93		21		06		06	
		N 93		21		06		06	

The article no. for the selected Rapid valve gate system, single needle valve ENV, with pneumatic drive and nozzle type 6NHF60 is:

**N93210606HF-1-ENV**

You can add a pitch distance, straight line, radius or angle, needle guide (LA/LAZ), gate point Ø and needle drive with housing or without housing to your specifications.

**Delivery time three working weeks.**

<sup>1</sup> Configuration option S-096: Needle guide with reduced contact surface.

<sup>2</sup> Configuration option: with housing or without housing.